

WEST SUSSEX COUNTY COUNCIL ((MID SUSSEX DISTRICT)
(PARKING PLACES AND TRAFFIC REGULATION)
(CONSOLIDATION No.2) ORDER 2006)
(HAYWARDS HEATH: LUCASTES ROAD AND LUCAS WAY AMENDMENT)
ORDER 2014

HAYWARDS HEATH: LOCATION OF WAITING RESTRICTIONS

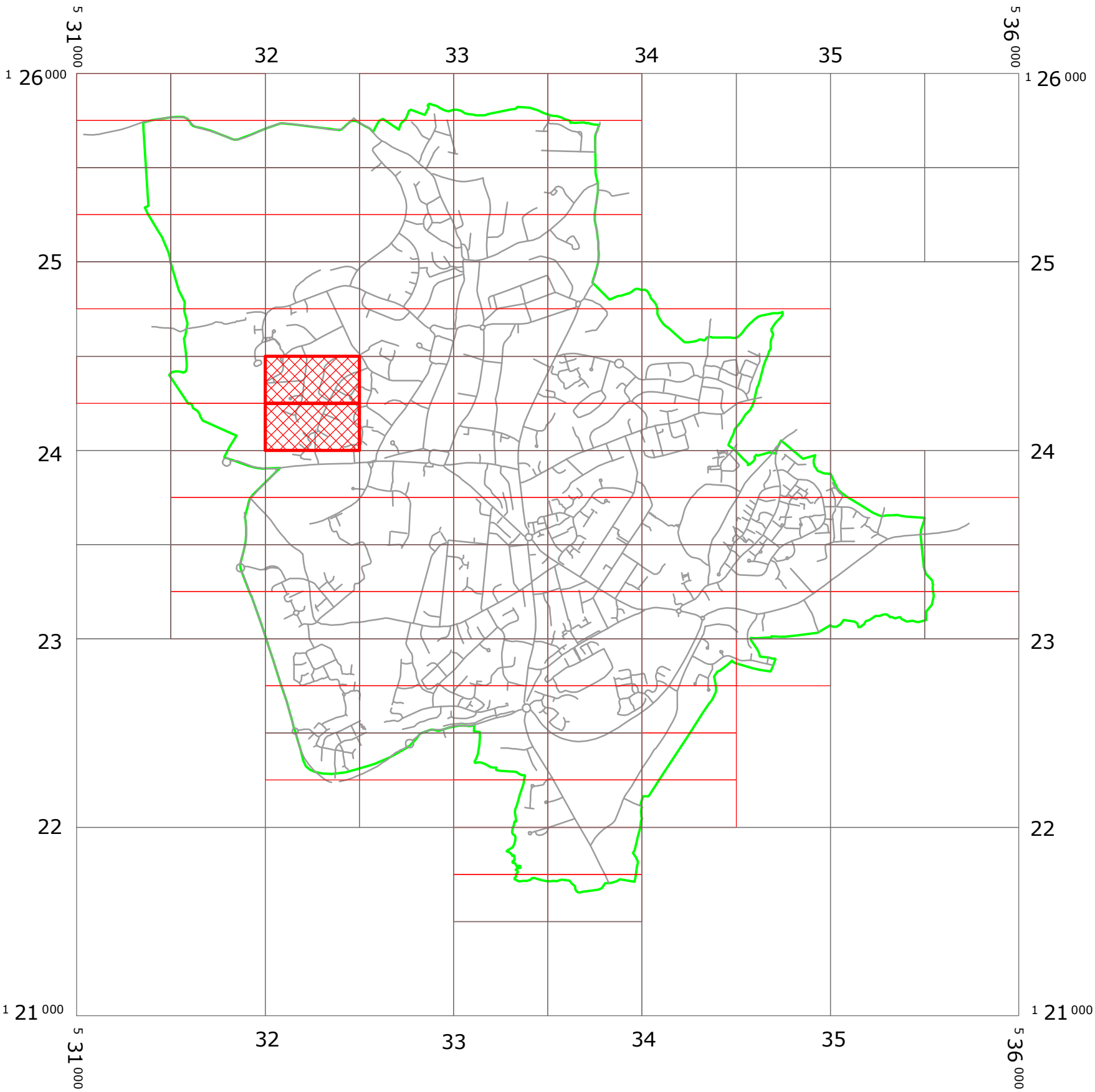

KEY:

OS TILE GRID

PARKING TILE GRID

LOCATION OF WAITING RESTRICTIONS

PARISH BOUNDARY

ROAD NETWORK



West Sussex County Council
Communities & Infrastructure
The Grange
Tower Street
Chichester
West Sussex
PO19 1RH

WEST SUSSEX COUNTY COUNCIL ((MID SUSSEX DISTRICT)
(PARKING PLACES AND TRAFFIC REGULATION)
(CONSOLIDATION No.2) ORDER 2006)
(HAYWARDS HEATH: LUCASTES ROAD AND LUCAS WAY AMENDMENT)
ORDER 2014
LOCATION OF WAITING RESTRICTIONS



Reproduced from or based upon 2013 Ordnance Survey material with permission of the Controller of HMSO
(c) Crown Copyright reserved. Unauthorised reproduction infringes Crown copyright and may lead to
prosecution or civil proceedings West Sussex County Council Licence No. 100023447

SCALE: 1:25,000
DATE: 08/08/2014

Key for Waiting Restrictions

All areas over which the provision of the orders apply are defined by the shaded areas as shown on the following plans plus a contiguous area not indicated on the plans of verge and/or footway between the carriageway edge and the highway boundary. The plans in this schedule are based upon grid references of the Ordnance Survey National Grid defined by the OSGB 36 triangulation.

Prohibition of waiting at any time

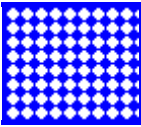
101		check	No waiting at any time
126		z_circle	No waiting 9.00am-10.00am, 1.00pm-2.00pm Mon-Fri

WEST SUSSEX COUNTY COUNCIL
((MID SUSSEX DISTRICT) (PARKING PLACES & TRAFFIC REGULATION)
(CONSOLIDATION NO.2) ORDER 2006)

(HAYWARDS HEATH: LUCASTES ROAD AND LUCAS WAY AMENDMENT)
ORDER 2014

West Sussex County Council in exercise of their powers under Sections 1 (1) 2 (1) and (2), 4 (2), 45, 46, 49 and 53 and Part IV of Schedule 9 of the Road Traffic Regulation Act 1984 ("the Act") as amended and of all other enabling powers and after consultation with the Chief Officer of Police in accordance with Part III of Schedule 9 to the Act hereby make the following Order:-

1. This Order shall come into operation on the Eighth day of August 2014 and may be cited as "West Sussex County Council ((Mid Sussex District) (Parking Places & Traffic Regulation) (Consolidation No.2) Order 2014) (Haywards Heath: Lucastes Road and Lucas Way Amendment) Order 2014".
2. The "West Sussex County Council (Mid Sussex District) (Parking Places & Traffic Regulation) (Consolidation No.2) Order 2006" is hereby amended by the replacement of the plans specified in the First Schedule to this Order, with the plans specified in the Second Schedule, attached hereto.

FIRST SCHEDULE
Plans to be Replaced

TQ3224SWN (Issue Number 4)
TQ3224SWS (Issue Number 4)

SECOND SCHEDULE
Replacement Plans

TQ3224SWN (Issue Number 5)
TQ3224SWS (Issue Number 5)

THE Common Seal of THE
WEST SUSSEX COUNTY COUNCIL
was hereto affixed the

day of ^{SEVENTH} August 2014



Authorised Signatory
CMS1040-MM

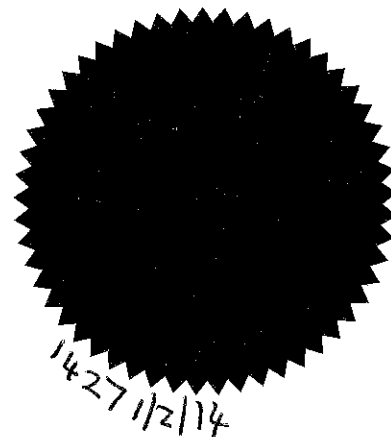

04/08 DELEGATED AUTHORITY

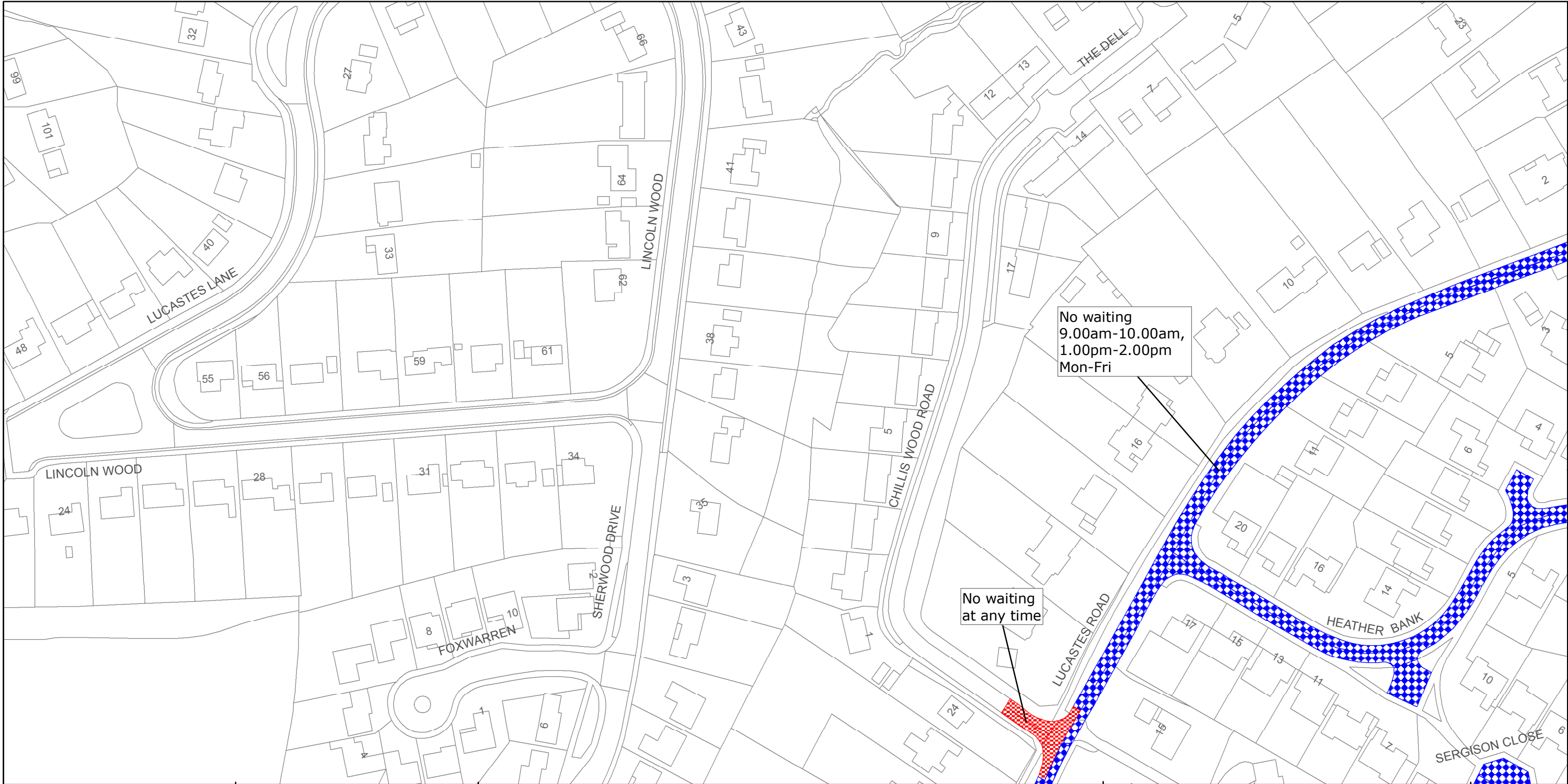

West Sussex County Council
Highways & Transport
The Grange
Tower Street
Chichester
West Sussex
PO19 1RH

MID SUSSEX DISTRICT: HAYWARDS HEATH
WAITING RESTRICTIONS

Reproduced from or based upon 2013 Ordnance Survey material with permission of the Controller of HMSO (c) Crown Copyright reserved.
Unauthorised reproduction infringes Crown copyright and may lead to prosecution or civil proceedings West Sussex County Council Licence No. 100023447

TILE REF NO:
TQ3224SWN

SHEET ISSUE NO 5
SHEET ACTIVE FROM - 08/08/2014



N

SCALE:
1:1250
at A3 size

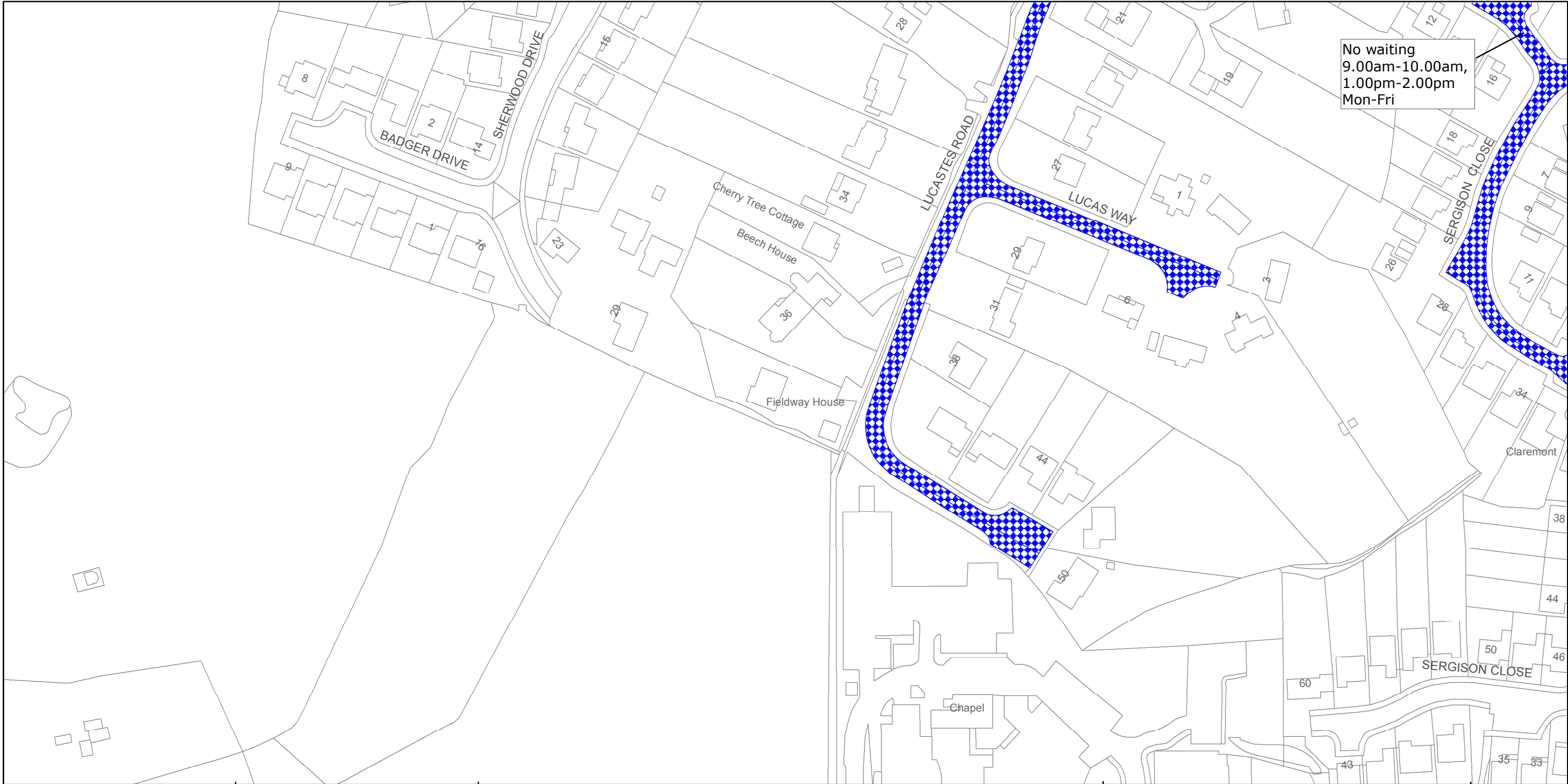

West Sussex County Council
Highways & Transport
The Grange
Tower Street
Chichester
West Sussex
PO19 1RH

MID SUSSEX DISTRICT: HAYWARDS HEATH
WAITING RESTRICTIONS

Reproduced from or based upon 2013 Ordnance Survey material with permission of the Controller of HMSO (c) Crown Copyright reserved.
Unauthorised reproduction infringes Crown copyright and may lead to prosecution or civil proceedings West Sussex County Council Licence No. 100023447

TILE REF NO:
TQ3224SWS

SHEET ISSUE NO 5
SHEET ACTIVE FROM - 08/08/2014



SCALE:
1:1250
at A3 size